

34,752 SF AVAILABLE

SUITES FROM 4,800 SF

M3

COMMERCE
CENTER

BUILDING A

1001-1061 ANDOVER PARK EAST
TUKWILA, WA



PROJECT SPECIFICS



SITE

3 Building Park Featuring
Showroom/Flex/Industrial Spaces



LOADING

Dock and Grade
Loading

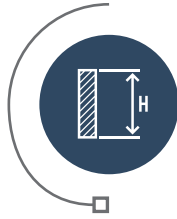

CLEAR HEIGHT

24' Clear Height

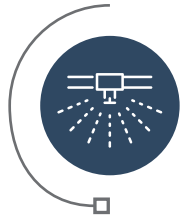

SPRINKLERED

Fully Sprinklered



VISIBILITY

High Visibility and Frontage
on Andover Park E



PARKING

Excellent Truck Maneuvering
Abundant Vehicle Parking



AVAILABLE DATE
NOW - 2025



BUILDING A

SUITE 1037
4,800 SF
Office: 360 SF
1 DH
Available Now

Key

Warehouse Office Dock High Doors Grade Level Doors

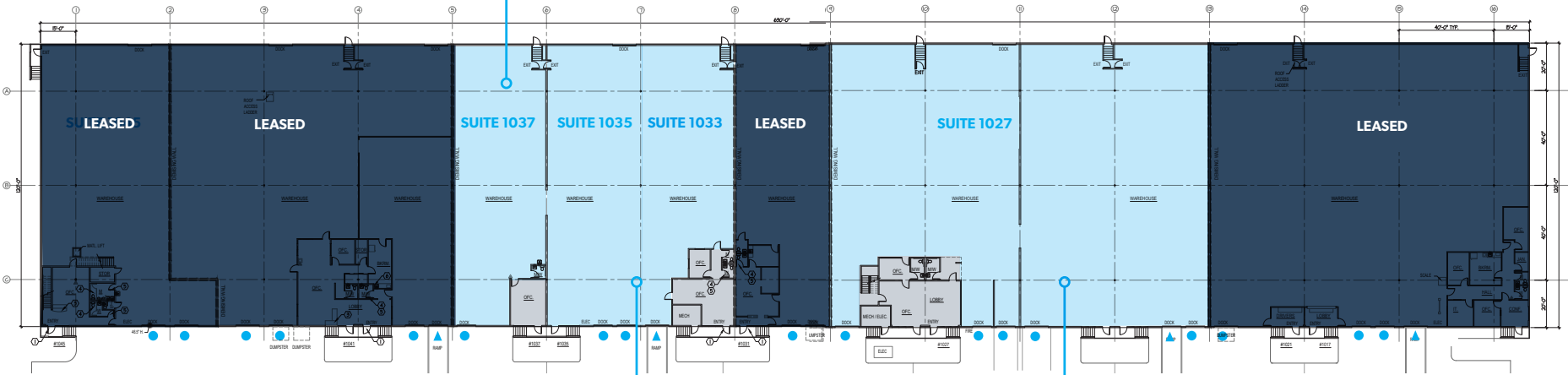

SUITES 1035 +1033
9,600 SF
Office: 811 SF
2 DH / 1 GL
Available Now

SUITE 1027
20,352 SF
Office: 967 SF
5 DH / 1 GL
Available 2/1/25

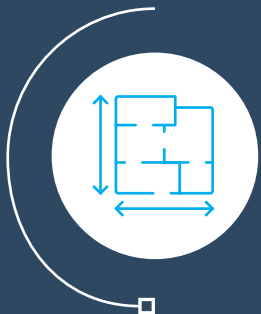

34,752 TOTAL SQUARE FEET
14,400 SF AVAILABLE NOW
Additional 19,218 SF Available 2/1/25



PROPERTY LOCATION

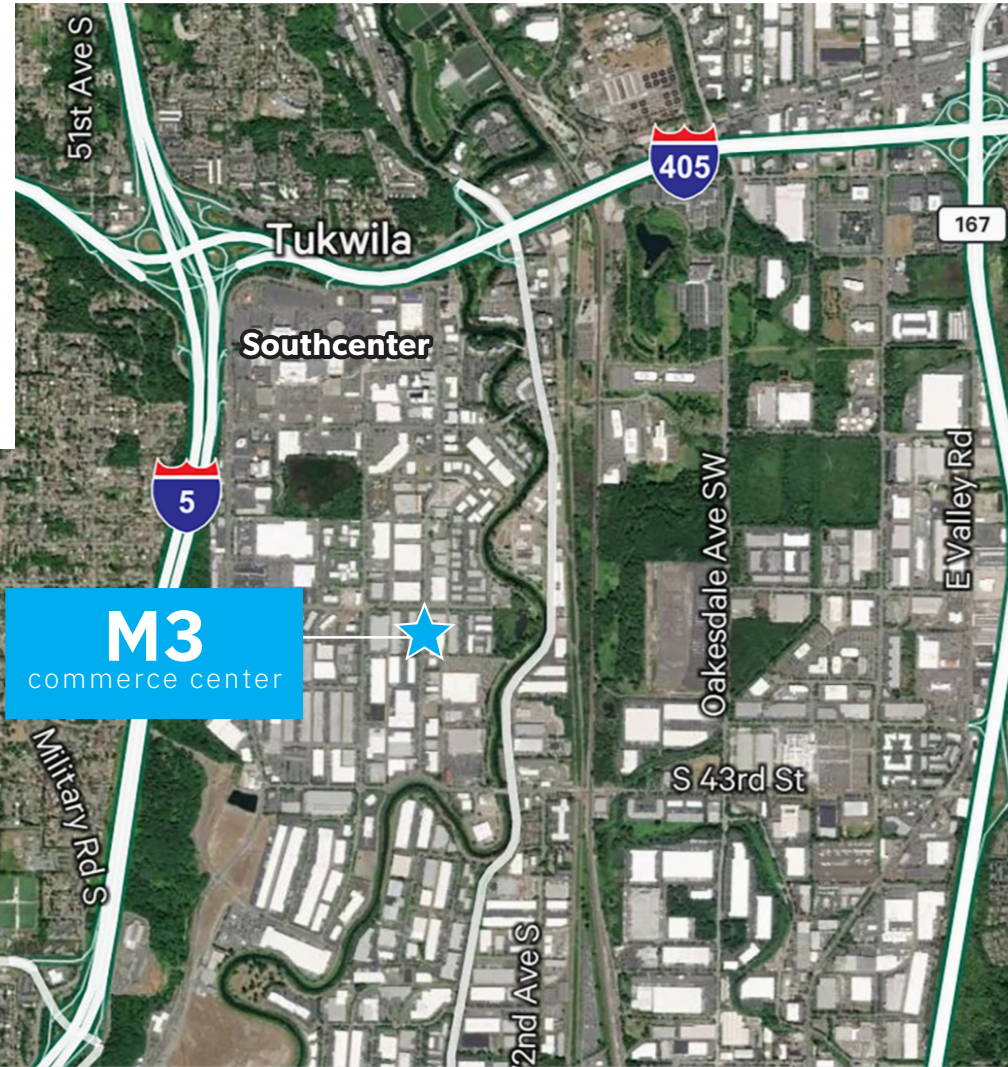

2 MINUTES
TO SOUTHCENTER MALL



8 MINUTES
TO SEATAC AIRPORT



13 MINUTES
TO SEATTLE



16 MINUTES
TO BELLEVUE



25 MINUTES
TO TACOMA

M3

COMMERCE CENTER

1001-1061 ANDOVER PARK EAST
TUKWILA, WA

LEASING CONTACTS

GEORGE ROCKWELL, SIOR

Principal

+1 206 679 7625

grockwell@andoverco.com

ZAC SNEDEKER

Senior Vice President

+1 425 444 0133

zac.snedeker@cbre.com



© 2025 CBRE, Inc. All rights reserved. This information has been obtained from sources believed reliable, but has not been verified for accuracy or completeness. You should conduct a careful, independent investigation of the property and verify all information. Any reliance on this information is solely at your own risk. CBRE and the CBRE logo are service marks of CBRE, Inc. All other marks displayed on this document are the property of their respective owners, and the use of such logos does not imply any affiliation with or endorsement of CBRE. Photos herein are the property of their respective owners. Use of these images without the express written consent of the owner is prohibited.MK_JAN2025

