

9150 WILLOWS



Fenced, paved yard and small building
for lease (potential building BTS)

9150 WILLOWS RD NE | REDMOND, WA 98052

 Lift Partners

 **Kidder
Mathews**

FOR LEASE

9150 Willows Rd NE

9150 WILLOWS RD NE, REDMOND, WA 98052

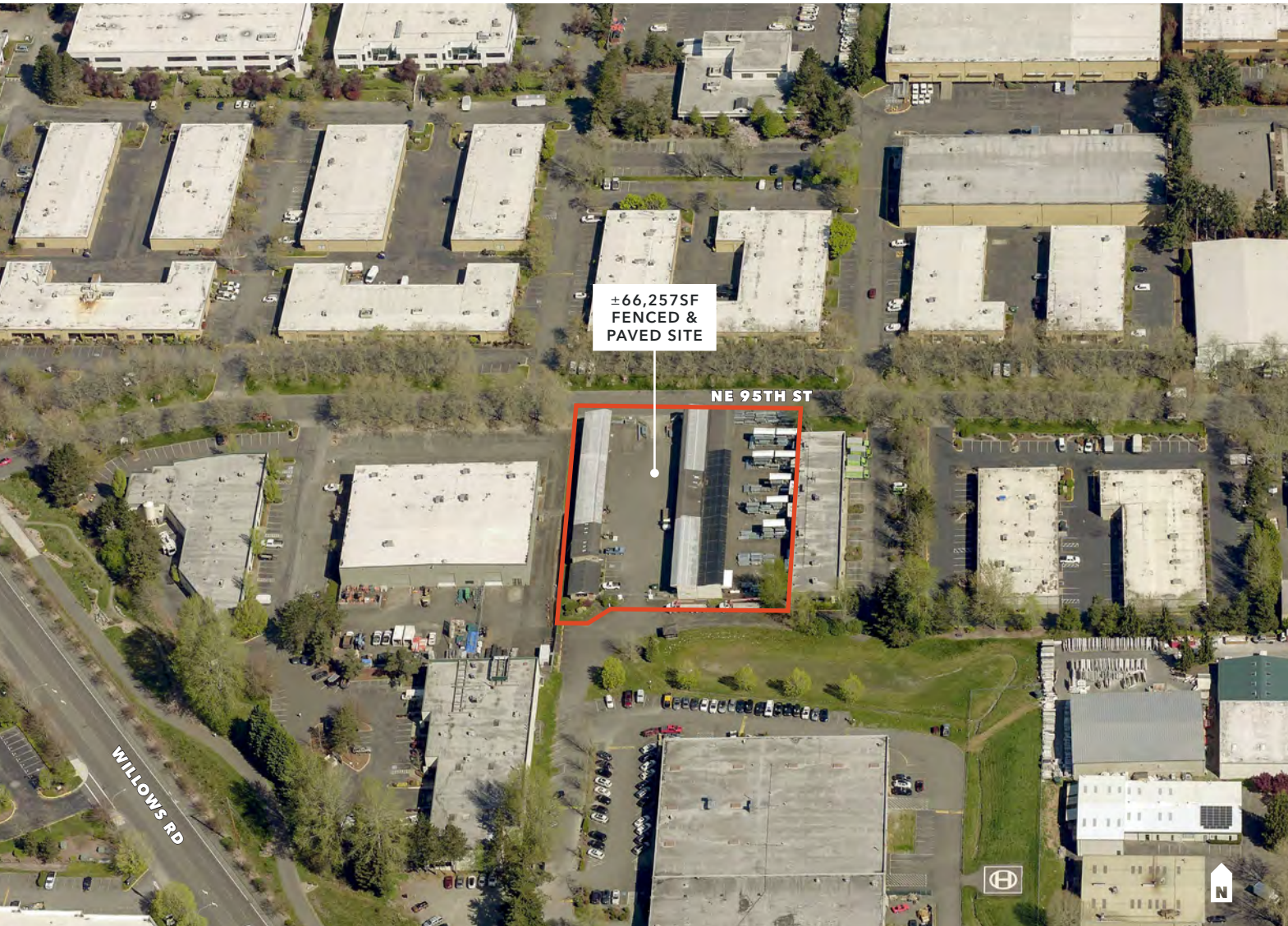

PROPERTY FEATURES

±4,500 SF structure

±66,257 SF fenced and paved site

PARKING for up to 137

AVAILABLE now

CONTACT brokers for lease rates

POTENTIAL build-to-suit opportunity for an ±18,000 SF office/warehouse building

TODD GAUTHIER

425.450.1118

todd.gauthier@kidder.com

JASON BLOOM

425.450.1102

jason.bloom@kidder.com

KIDDER.COM

This information supplied herein is from sources we deem reliable. It is provided without any representation, warranty, or guarantee, expressed or implied as to its accuracy. Prospective Buyer or Tenant should conduct an independent investigation and verification of all matters deemed to be material, including, but not limited to, statements of income and expenses. Consult your attorney, accountant, or other professional advisor.

 **Kidder Mathews**

FOR LEASE

9150 Willows Rd NE

9150 WILLOWS RD NE, REDMOND, WA 98052

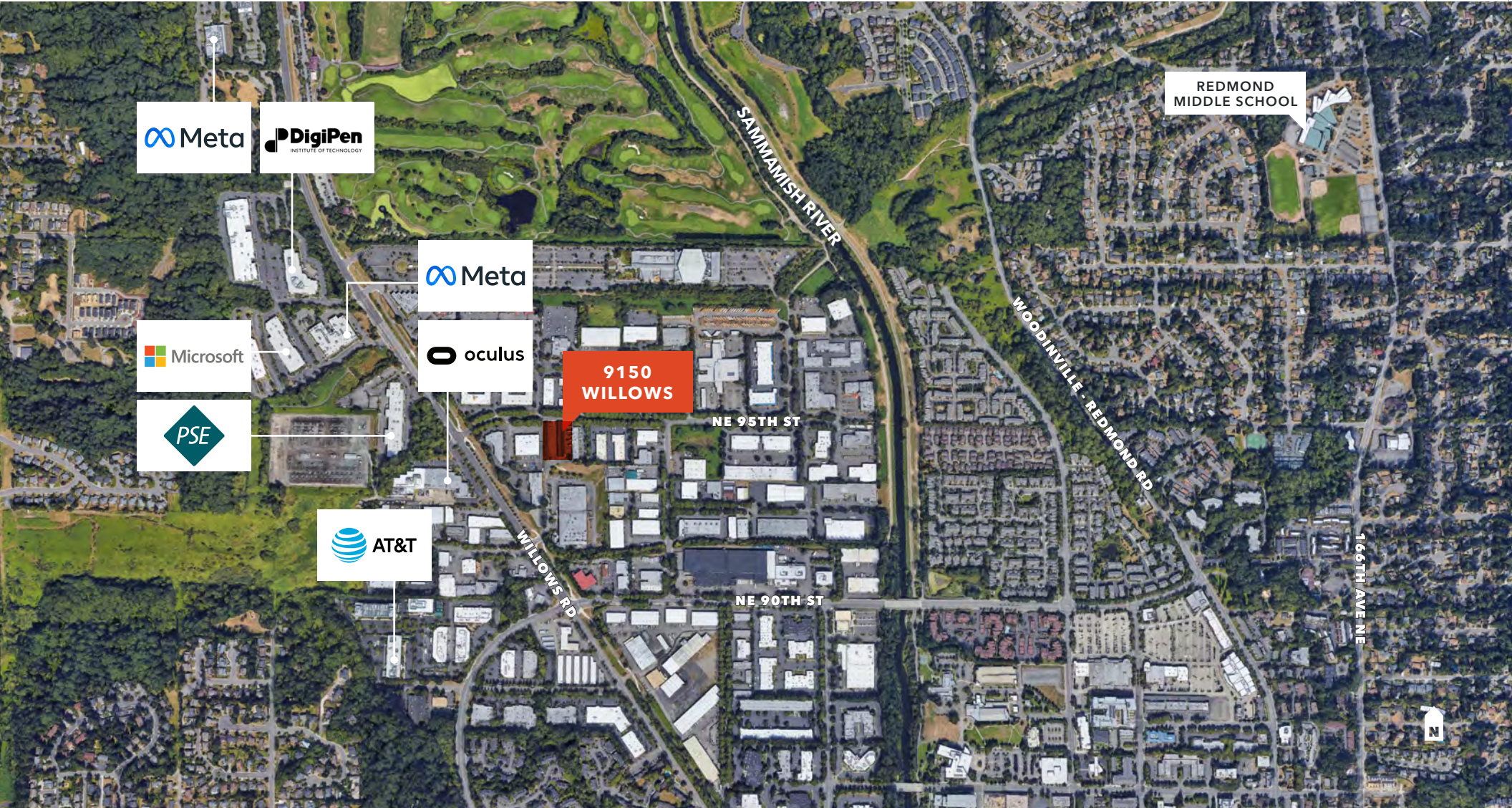

KIDDER.COM

This information supplied herein is from sources we deem reliable. It is provided without any representation, warranty, or guarantee, expressed or implied as to its accuracy. Prospective Buyer or Tenant should conduct an independent investigation and verification of all matters deemed to be material, including, but not limited to, statements of income and expenses. Consult your attorney, accountant, or other professional advisor.

